

INSTALLATION GUIDE

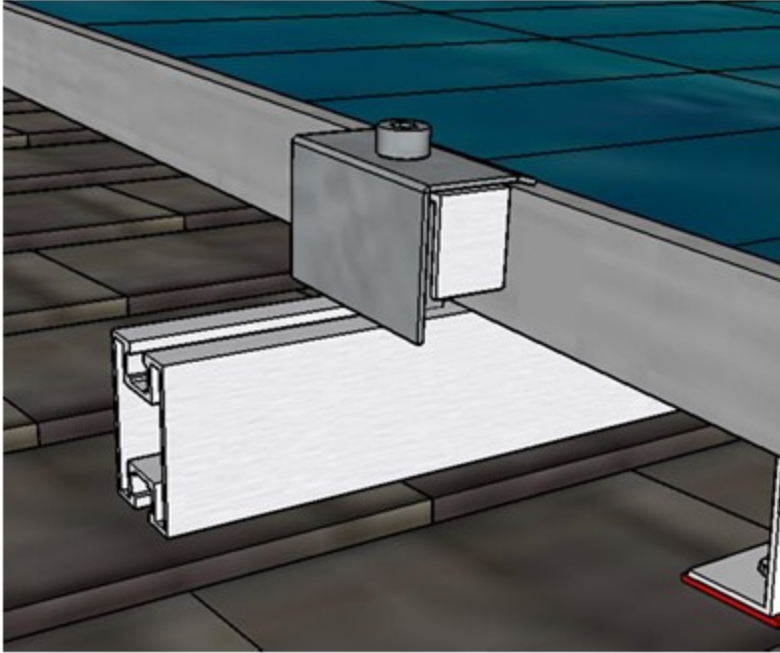

When installing the end clamp, clip the push-clip into the aluminium rail, make sure you hear the audible click. Move the aluminium spacer to be flush against the solar panel.

Tighten to 8Nm

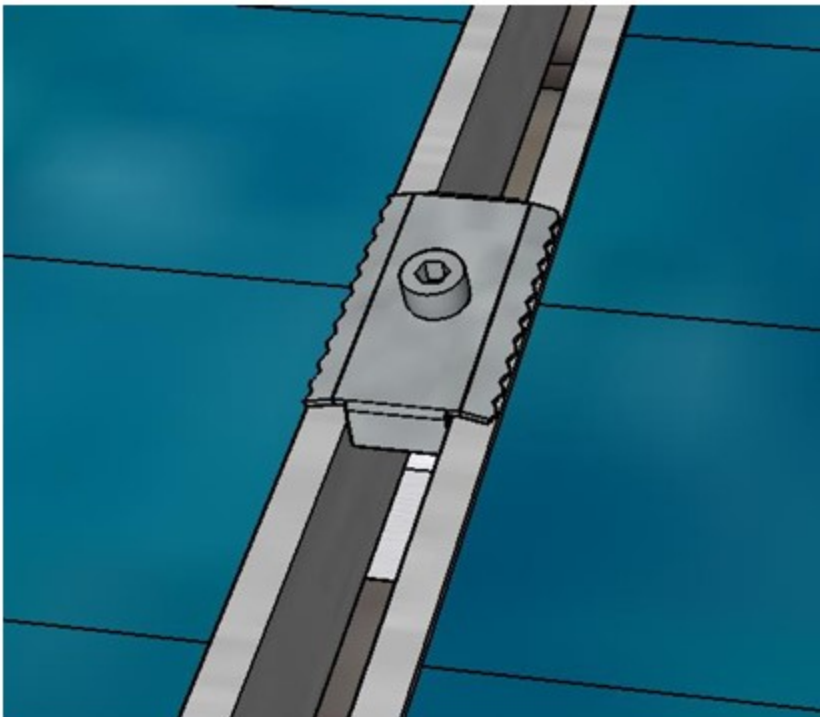

When installing the middle clamp, clip the push-clip into the aluminium rail, make sure you hear the audible click. Move the middle clamp so the bent spacer is flush against the Solar panel.

Tighten to 8Nm

Install the second panel by sliding the solar panel under the middle clamp, repeat end clamp procedure on last panel. Now align the solar panels to be straight

TIGHTEN ALL MIDDLE AND END CLAMPS TO BE 8NM