

KD SOLAR INSTALLATION GUIDE – KDS HIGH WIND TIER 2 AFRAME

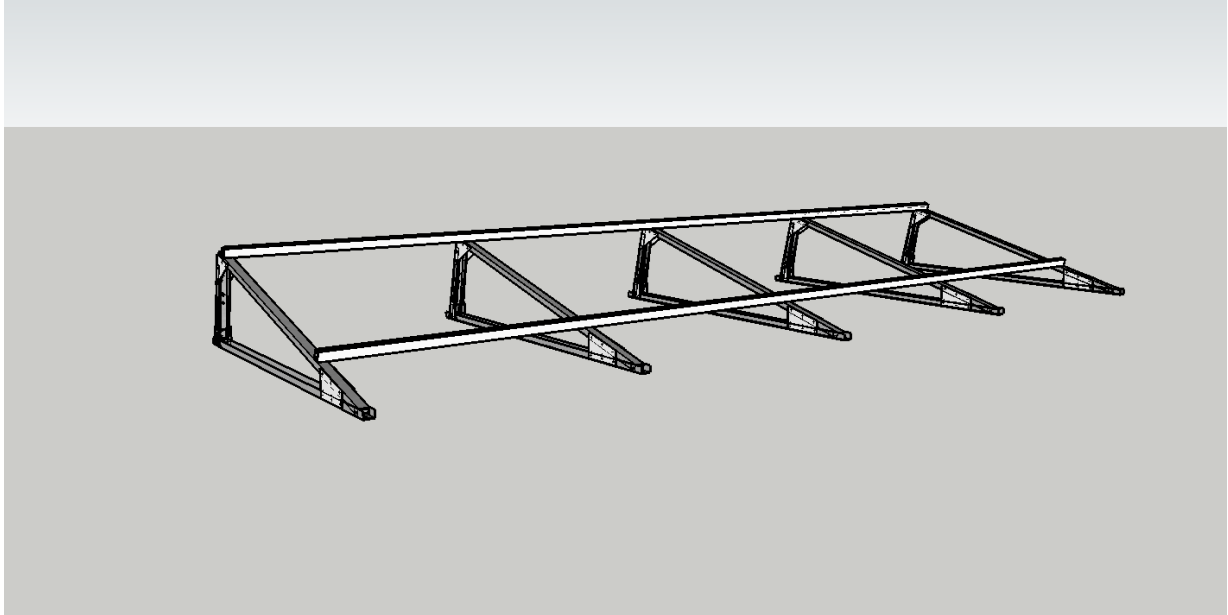

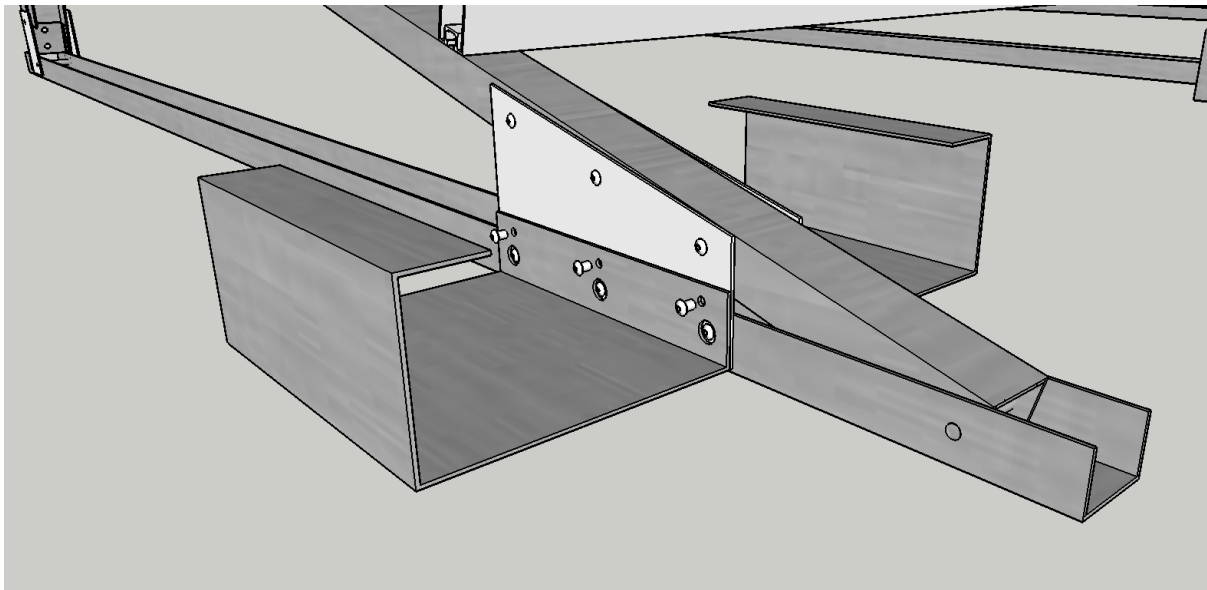

SPACE YOUR A FRAMES AND FASTEN THE RAIL ONTO THE TOP OF THE A FRAME USING THE BOLT, NUT, WASHER SUPPLIED.



USING THE POPRIVETS SUPPLIED. FASTEN THE FRONT BALLAST HOLDER TO THE FRONT OF THE AFRAME. POPRIVET USING THE DESIGNATED HOLES

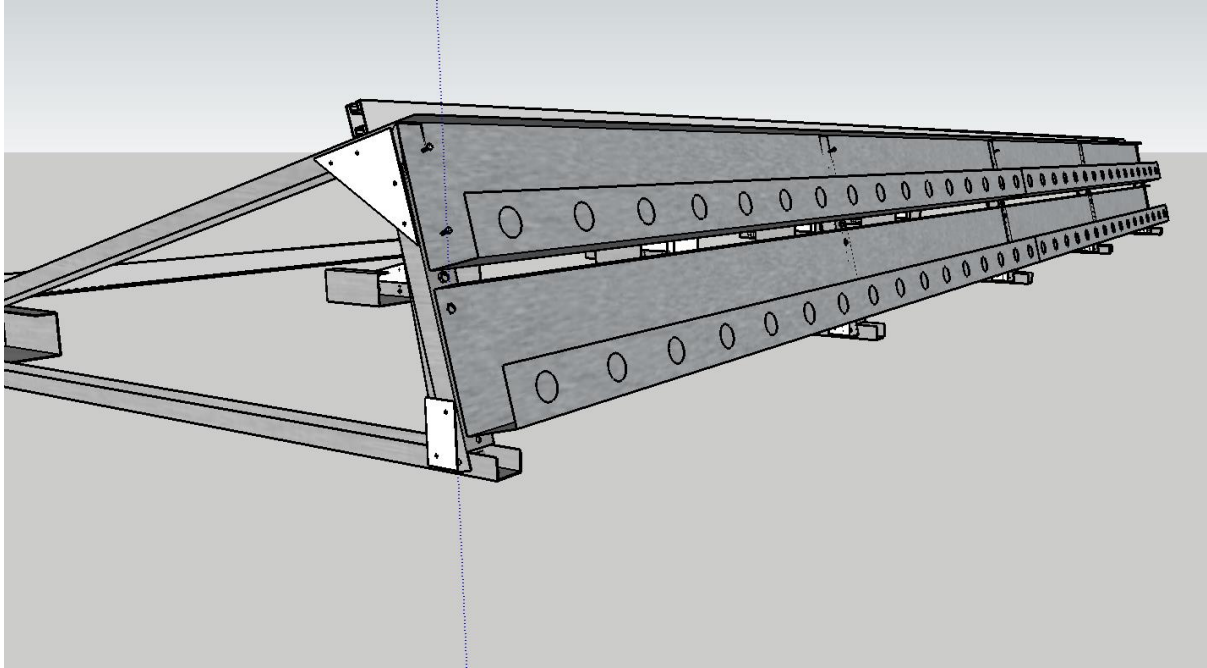

FASTEN THE REAR BALLAST HOLDERS TO THE REAR OF THE A FRAME USING THE TEKSCREWS PROVIDED. TWO ROWS OF BALLAST HOLDERS MUST BE INSTALLED ONTO THE REAR OF THE A FRAME

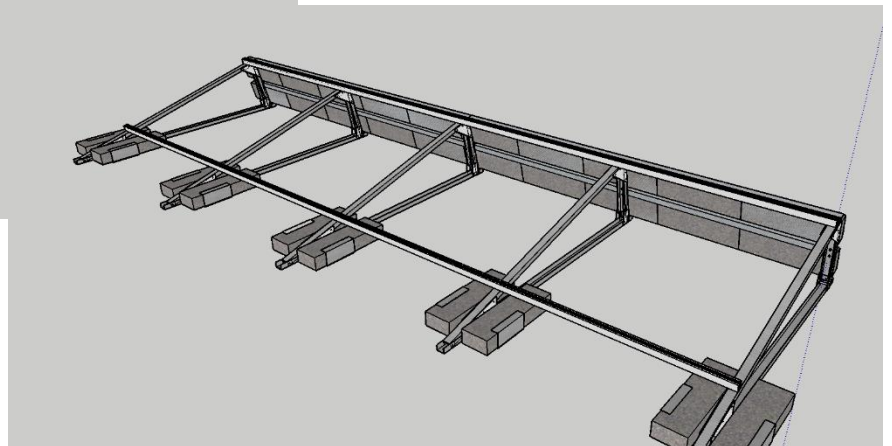
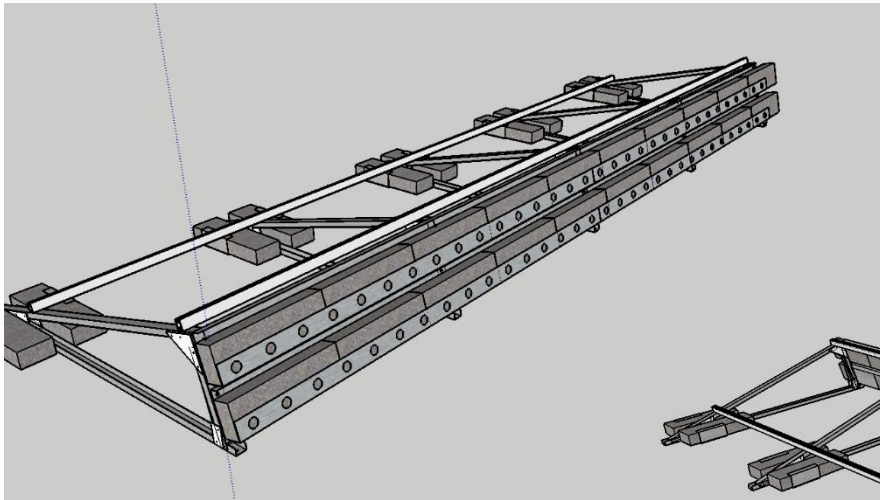

INSTALL THE BALLASTS. PLACE TWO BALLAST IN THE FRONT OF THE A FRAME, ONE PER BALLAST HOLDER.

FILL THE REAR WIND DEFLECTORS WITH BALLASTS.

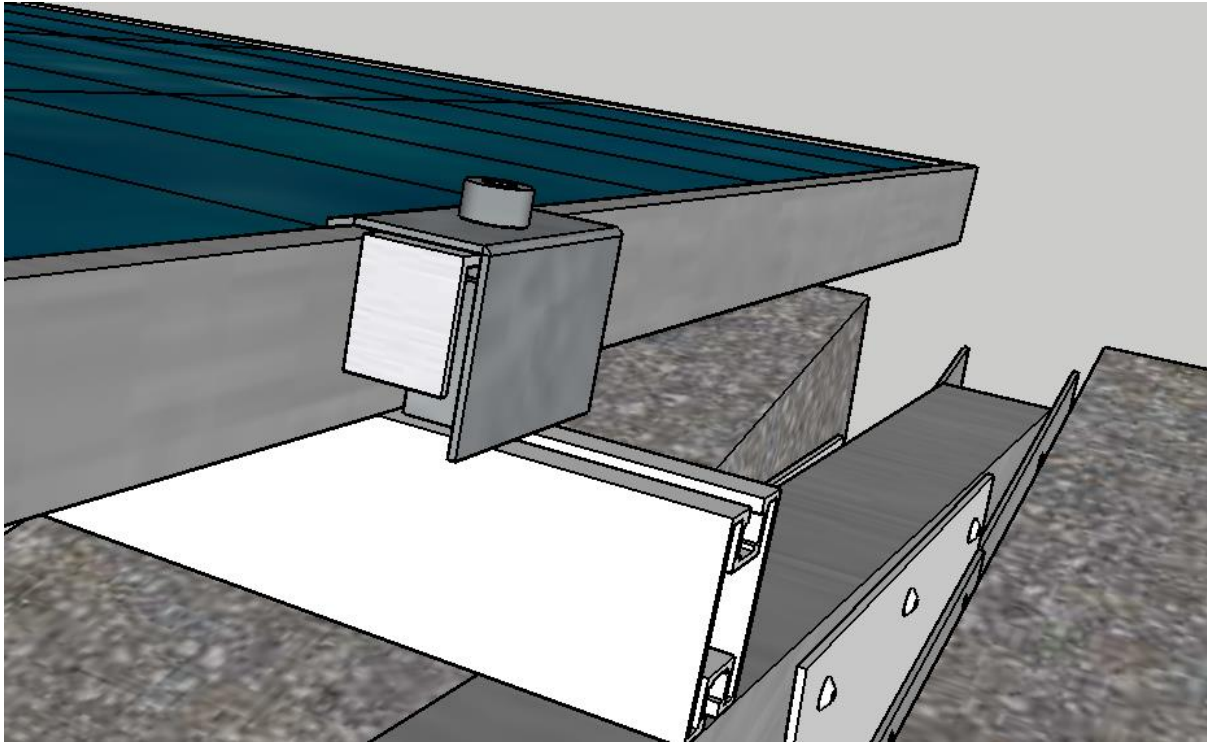

INSTALL THE END CLAMP BY CLIPPING THE PUSH CLIP INTO THE RAIL. MAKE SURE THE ALUMINIUM SPACER IS PRESSED AGAINST THE PANEL WHEN FASTENING THE END CLAMP. **TIGHTEN TO 8Nm**

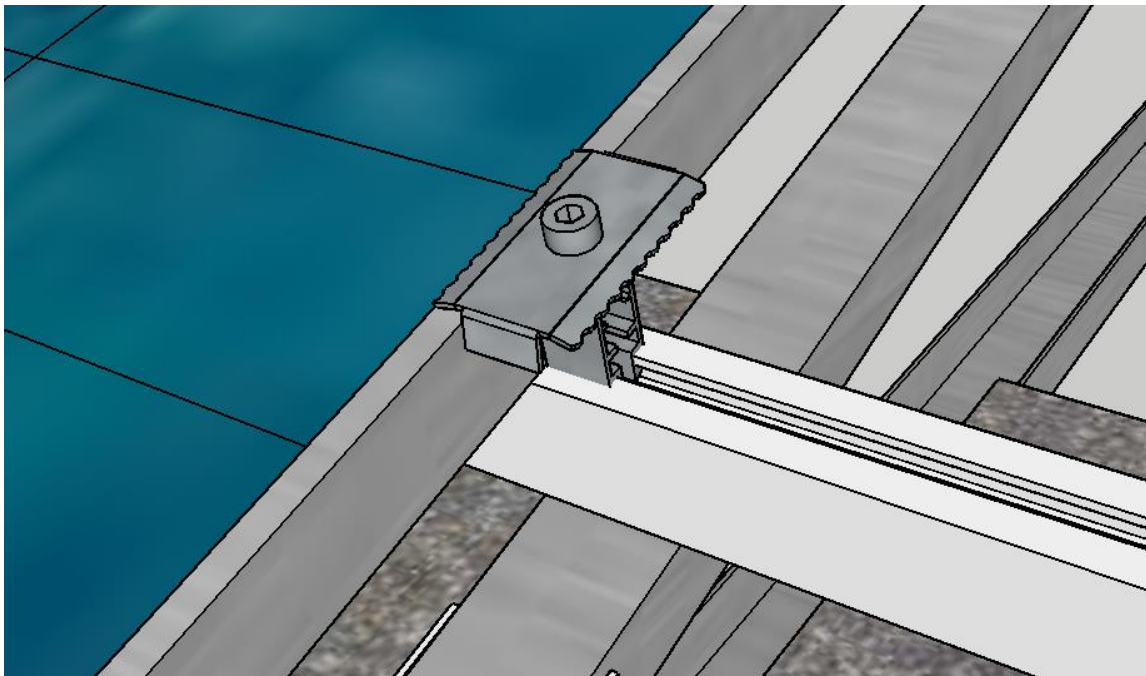

INSTALL THE MID CLAMP BY CLIPPING THE PUSH CLIP INTO THE RAIL. MAKE SURE THE SPACER IS PRESSED AGAINST THE PANEL WHEN FASTENING THE MID CLAMPS. **TIGHTEN TO 8Nm**

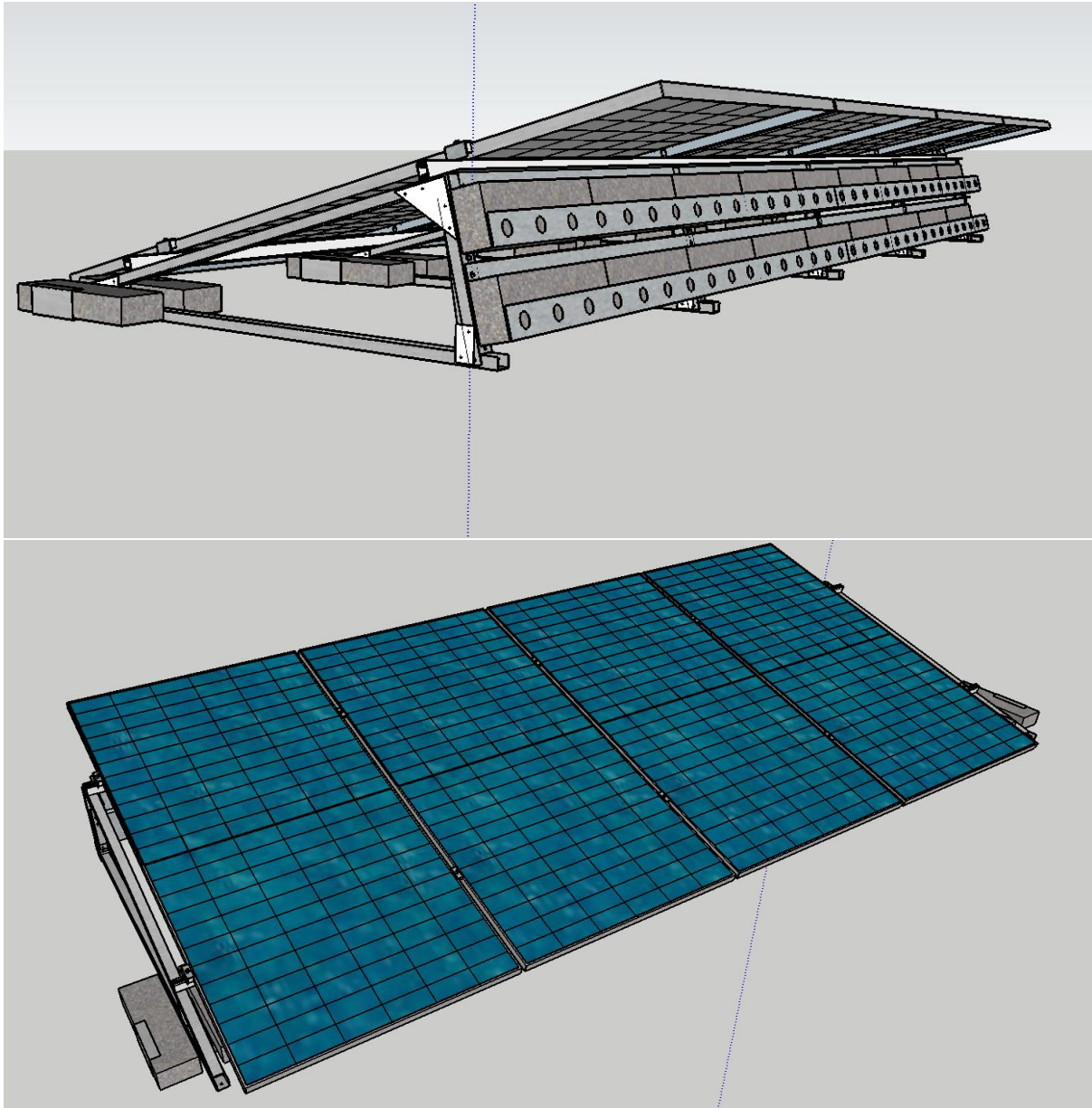

CONTINUE USING THIS METHOD
UNTIL ALL PANELS ARE INSTALLED.

ALL MID AND END CLAMPS MUST
BE TIGHTENED TO **8Nm**